

KOHLER®

Prolific® Under-Mount Kitchen Sink K-23650



Features:

- Large single bowl.
- 10-inch depth provides generous workspace.
- No faucet holes.
- Includes bamboo cutting board, two multipurpose grated racks, colander and washbin.
- Three graduated ledges in basin allow you to place accessories at your preferred height.
- Accessories stack and slide on ledges for a custom arrangement.
- Beveled cone-shape basin slopes into drain, easily disposing debris.
- Large size cutting board (21"x16") included with sink - covers entire sink.
- Also available: Medium size cutting board 10"x16" - covers half the sink. (Sold separately # K-5541-NA)
- SilentShield® sound-absorption technology offers quieter performance.
- Includes installation hardware.
- Works with all standard countertop thicknesses. Pairs best with 3cm countertop thickness if a flush surface between counter and cutting board is desired.

Material:

- Premium 18-gauge stainless steel.

Installation:

- Undermount.
- Minimum base cabinet width: 24"-27"
(24" may require cabinet modifications).

Recommended Products/Accessories

- K-23729 Stainless steel cleaner

Included Components

- A. K-5544 Colander and Washbin
- B. K-5542 Multipurpose Grated Rack (2)
- C. K-23680 Large Bamboo Cutting Board



Codes/Standards:

ASME A112.19.3/CSA B45.4

Lifetime Limited Warranty for KOHLER® Stainless Steel Sinks

See website for detailed warranty information.



Pacific Northwest
9805 32nd Ave. S
Lakewood, WA
98499

Northern & Central California
1905 N. MacArthur Dr. Suite #300
Tracy, CA
95376

Southern California
3351 Grapevine St. Suite #A
Mira Loma, CA
91752

For more information, visit us at www.4willis.com or e-mail us at info@4willis.com.

1-800-4KOHLER (1-800-456-4537) Kohler Co. reserves the right to make revisions without notice to product specifications.
For the most current Specification Sheet, go to www.kohler.com. CA-Willis

KOHLER®

Prolific®

Under-Mount Kitchen Sink

K-23650

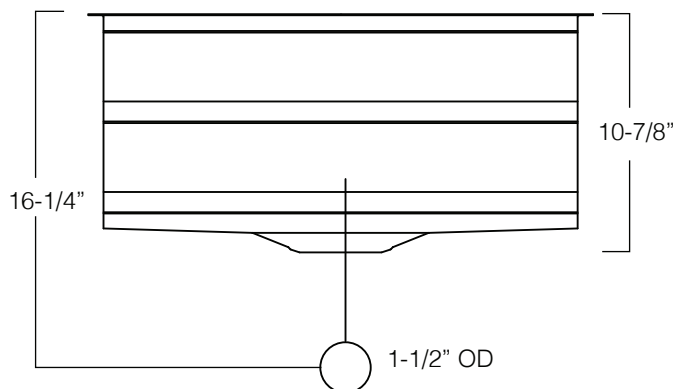
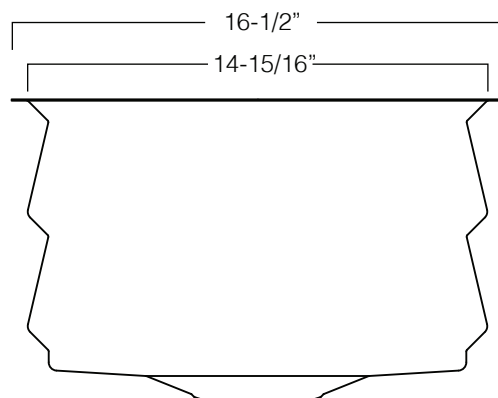
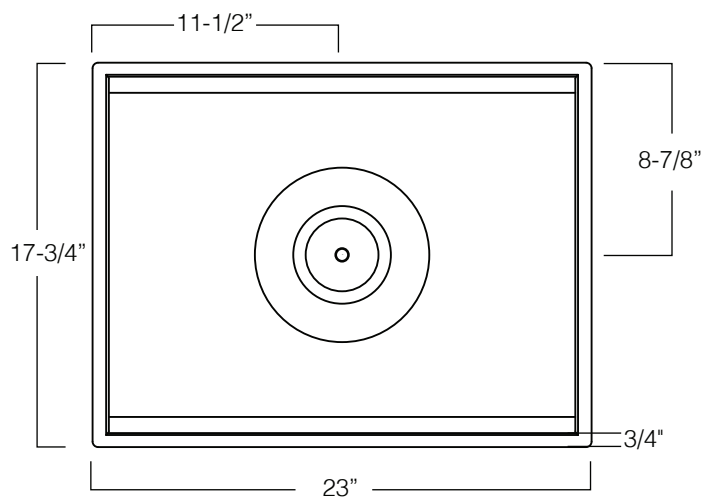

Technical Information:

Installation: Under-mount

Min. base cabinet width: 24"

Bowl area (Only): Length: 21-1/2"

Width: 14-15/16"

Bowl depth: 9-15/16"

Water depth: 9-15/16"

Drain Hole: 3-3/4"

Template: 1311445-7, required, included

Notes:

Install this product according to the installation instructions.

Countertop manufacturer or cutter must use the cut-out template provided with the product, or a current one provided by Kohler Co. (call 1-800-43-FOCUS). Kohler Co. is not responsible for cut-out errors when the incorrect cut-out template is used.



Pacific Northwest
9805 32nd Ave. S
Lakewood, WA
98499

Northern & Central California
1905 N. MacArthur Dr. Suite #300
Tracy, CA
95376

Southern California
3351 Grapevine St. Suite #A
Mira Loma, CA
91752

For more information, visit us at www.4willis.com or e-mail us at info@4willis.com.

1-800-4KOHLER (1-800-456-4537) Kohler Co. reserves the right to make revisions without notice to product specifications.

For the most current Specification Sheet, go to www.kohler.com. CA-Willis